

# Quick Start Guide

## What's in the Box

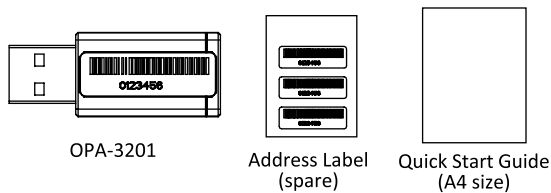

## Introduction

- The OPA-3201 is a USB adapter designed for Opticon wireless scanners.
- Read this quick start guide carefully before installing and/or using this product.
- Keep this quick start guide for future reference and store it in a safe place.

## Precautions

### Warning

- Do not throw this device into a fire. Doing so may cause the case to burst, resulting in injury or possibly acting as an accelerant for the fire.
- Keep the device out of the reach of small children.

### Caution

#### 1. Handling

- Do not disassemble the device. It may cause heat, fire and injury.
- Do not operate the device while walking or driving a vehicle. It may cause accidents.
- Do not put heavy items on this product and do not apply any shock to the device. The device may get broken resulting in injury.
- Do not store this device in an extremely cold or hot environment. It may cause fire, deformation and malfunction of the device.
- Do not put this device close to fire. It may cause fire and an accident.
- Do not use this device near combustible materials. It may result in rupture and ignition of the device.
- Do not use this product near water or other liquids. It may cause the device to malfunction.
- Do not store this device in dusty environments and in extremely high humidity.
- Avoid static electricity and do not put this device near a radio or a TV. Excessive static electricity may cause malfunctions.
- If condensation has formed on the device, do not use it until moisture has evaporated to prevent malfunctions.
- When cleaning this product, rub gently with either a soft dry cloth or a damp cloth with mild detergent.

#### 2. Radio Law

This product qualifies as specified radio equipment for radio stations of 2.4 GHz band data communication system and has obtained the Certification for Construction Design of Specified Radio Equipment. Therefore, radio station license is not required in Japan.

The following activities are prohibited under the Radio Law:

- Remodeling and disassembly
- Peeling off the certificate label

#### 3. Wireless Communication

- This product is dedicated to Opticon wireless scanners and a wireless connection to any other device is not guaranteed.
- This product and the Opticon wireless scanners use the 2.4 GHz frequency band that is shared among other devices. It may affect the communication speed and distance between this product and the scanners.
- The communication speed and distance vary depending on the interference and radio wave condition between this product and the scanners.

#### 4. Trademark Notice

- Other product and company names mentioned herein may be trademarks or registered trademarks of their respective owners.

## Basic Specifications

Dimensions	43.8 x 8.3 x 17.4 (WDH mm)
Weight	Approx. 6 g
USB	HID keyboard
Power Supply	USB Low-Power class
Exterior plastics	Molded ABS plastics
Environmental Specifications	Operation temperature : 0 to 50 °C, 20 to 85%RH Storage temperature : -20 to 60 °C, 20 to 85%RH (non-condensing)
Others	Compliant with RoHS

## Detailed View

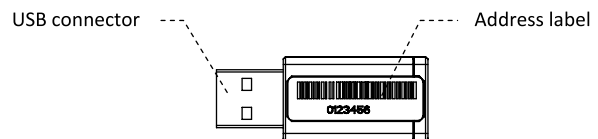

## Connection Procedure

### Initial Use

When the OPA-3201 is paired with an Opticon scanner for the first time, the scanner must be set to HID keyboard interface.

Follow the procedure below to configure the scanner, and then read the address bar code of the OPA-3201.

#### For 1D Scanner

Scan the following menu bar codes from the top to the bottom.

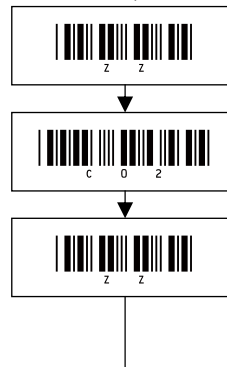

#### For 2D Scanner

Scan the following menu code.

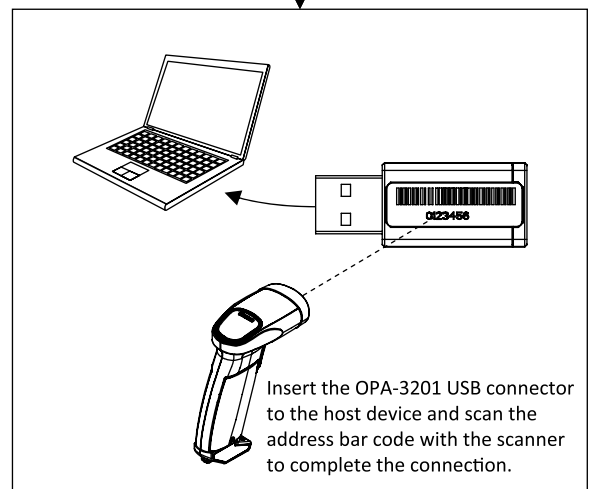

### Reconnection

When making the wireless connection again, the scanner does not need to read the menu codes again.

Read a common 1D bar code or 2D code or the OPA-3201's address bar code. For other reconnection procedure, refer to the scanner user's guide.

## Contact

<b>The Netherlands</b>	Opticon Sensors Europe B.V. tel: +31 (0)23-5692700 email: sales@opticon.com	<b>USA</b>	Opticon Inc. tel: (425) 651-2120 email: sales@opticonusa.com
<b>France</b>	Opticon S.A.S.U. tel: +33 (0)1-55 90 56 40 email: frsales@opticon.com	<b>China</b>	Opticon Trading Shanghai Co., Ltd. tel: +86-21-55500321 email: china@opticon.com
<b>Germany</b>	Opticon Sensoren GmbH tel: +49 (0)6074-91890-0 email: sales.de@opticon.com	<b>Taiwan</b>	Opticon Sensors Europe B.V. Taiwan Branch Office tel: +886 2-27597444 email: taiwan@opticon.com
<b>Italy</b>	Opticon S.r.l. tel: +39 051-6321800 email: sales.it@opticon.com	<b>Malaysia</b>	Opticon Malaysia Sdn. Bhd. tel: +60 (0)356122815 email:
<b>Sweden</b>	Opticon Sensors Nordic AB tel: +46 (0)8-58548560 email: sales.se@opticon.com	<b>Australia</b>	Opticon Sensors Pty. Ltd. tel: +61 (0)2-88754544 email: sales.au@opticon.com
<b>United Kingdom</b>	Opticon Limited tel: +44 (0)1582-635100 email: uksales@opticon.com	<b>Brazil</b>	Opticon Latin America tel: +55 11-5081 2088 email: sales.la@opticon.com